



**SOLD**



QLD **lots 801-817/430-456 Green Road CRESTMEAD,**

## DON'T MISS OUT! - NEW MEDIUM IMPACT INDUSTRY ESTATE

King & Co Property Consultants as exclusive agents are excited to present "GREEN ROAD INDUSTRIAL ESTATE" to the market for sale.

Zoned Medium Impact Industry, the estate will comprise 17 allotments. All of which are regular shaped and fully serviced. Lots will range in size from 2,002sqm to 5,084sqm.

Lot 801 ? Under Contract

Lot 802 ? Under Contract

Lot 803 ? Under Contract

Lot 804 ? Under Contract

Lot 805 ? Under Contract

Lot 806 ? Under Contract

The Estate is located metres from the propose

**David Chitham**

0407 347 931

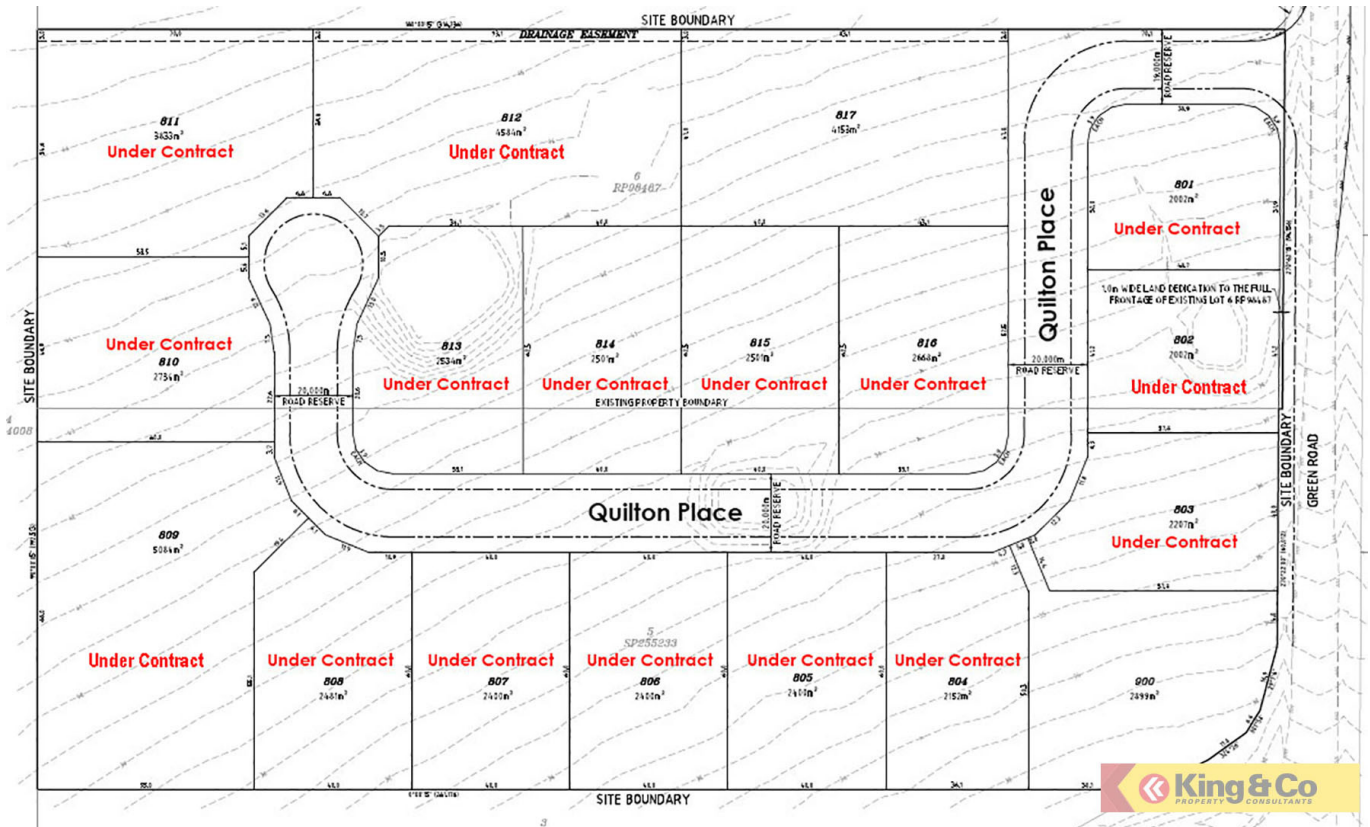

**Lots 801-817/430-456 Green Road CRESTMEAD, QLD**

